

NORTH 1/2  
NW 1/4 SEC. 8,  
T.4S., R.67W.,  
SIXTH P.M.

-- E. VIRGINIA AVE. --

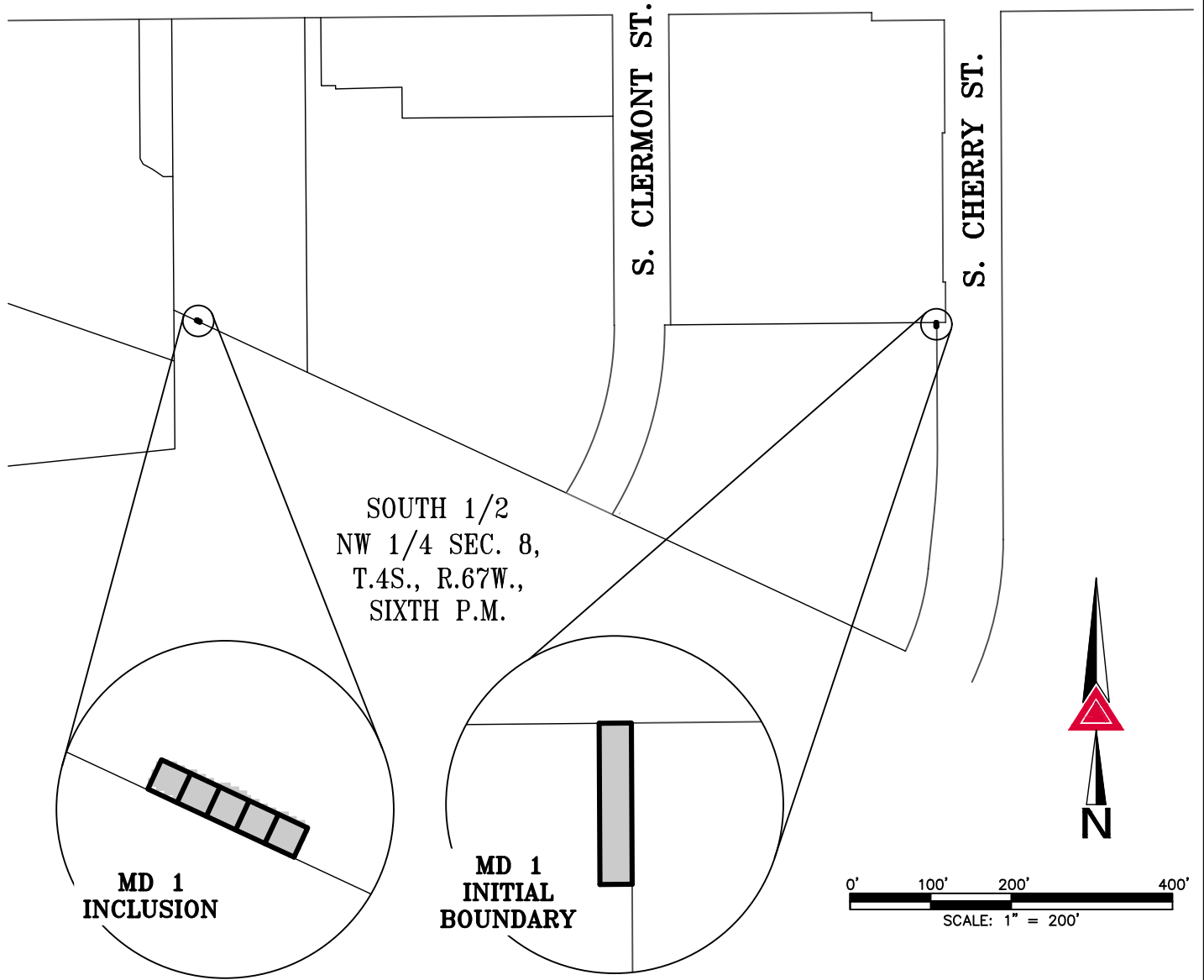

NOTE: THIS ILLUSTRATION DOES NOT REPRESENT A MONUMENTED LAND SURVEY AND IS ONLY INTENDED TO DEPICT THE ATTACHED LEGAL DESCRIPTION.